

NEWSFLASH

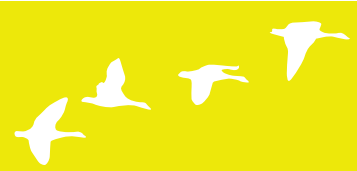

Two recent near misses have come to our attention:

The **first** incident occurred in North Wales, when a consignment of Scotch coated steel pipes was delivered to site from a coating facility near Cardiff. As the driver prepared to off load the pipes by loosening the restraining straps, some of the pipes rolled off the side of the lorry.

Fortunately the pipes fell off on the opposite side to the side the driver was standing; otherwise there would have been serious consequences. On investigating the loading configuration it was discovered that the pipes were supported on plain timber, without any profile to suit the shape of the pipes and simple wedges were used without any means of lateral restraint.



In some places nails were used to prevent the pipes from moving. (See photographs). The suppliers of the pipes and haulier are involved in the investigation process.

Recommendations:

All loads must be inspected for stability before the off loading process begins. If necessary the load should be refused and returned to the haulier's depot after being made safe.

Ensure that a suitable Safe System of Work (SSoW) is prepared and adopted on your sites for large one off type loads. In particular a SSoW should identify how personnel will access and be prevented from falling from materials where these are stacked high on the back of an articulated trailer.

Note: Similar incidents in recent years have led to fatalities or serious injuries to delivery drivers and construction personnel who were assisting in off loading operations.



The **second** incident occurred when a 5m x 0.8m wide Bison concrete floor plank delaminated whilst being lifted into position. Fortunately all of the falling pieces were retained in the safety net.

Bison representatives were involved in the subsequent investigation and they concluded that the failure was due to the fact that reinforcing loops, used to lift the plank during manufacture, had been inadvertently left in position and used to lift the plank on site.

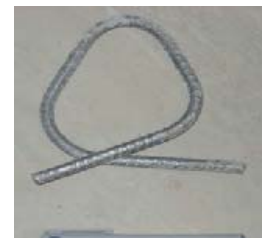

Recommendations:

Bison's procedures require that these reinforcing loops be cut off prior to planks leaving their factory. If they have been inadvertently left in situ they must not be used as lifting points on site. This is clearly stated on the delivery tickets.

Information sourced from the Major Contractors Group